

**Utilities Structures, Inc.**  
PO Box 9303  
2700 Evans Ave.  
Fort Myers, FL 33901

*"Your concrete pole producer since 1988"*

usipoles@aol.com  
www.utilitiesstructures.com

**USI40TIII-11686**

**Prestressed Concrete Pole**

- Pole Weight= 3,280lbs
- Wind speed= 180mph Vult
- Exposure = "C"
- Risk Category II
- Wind Gust = 3 seconds
- 8th Edition 2023 FBC 1620 HVHZ, 1609, 1806
- ASCE 7-22
- Concrete= 7,500lbs @ 28 days
- Grd. Wire= #6 Copper
- Strand= (4) .500" @ 70% Ultimate + (4) .500"
- Tenon= 2.375" x 5" Galv Tenon

**MP STRUCTURES**  
**RUTH POWELL, P.E., S.E.**

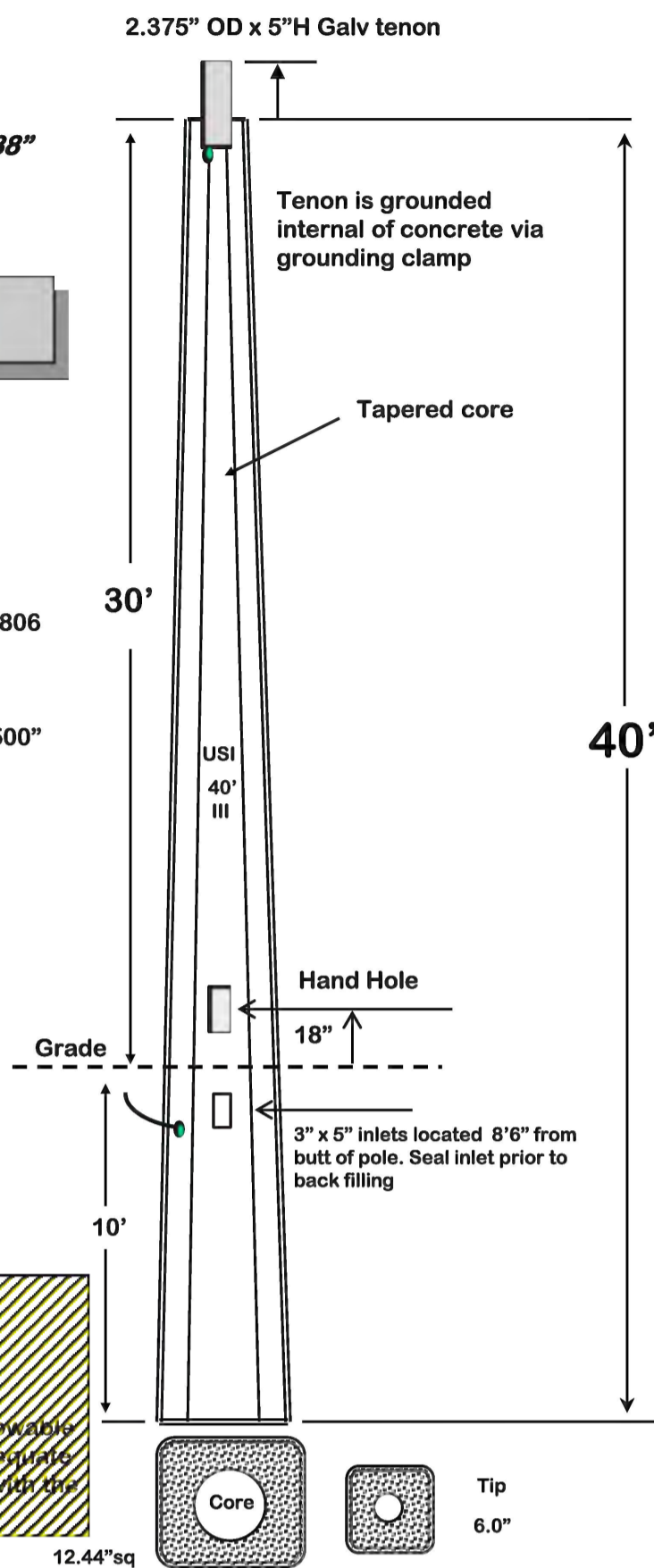

**PROJECT:**

This pole embedded 10' in to soils with an allowable passive pressure of 300psf is structurally adequate to resist the local wind speeds RHWIND CO. with the 3.0540 gpa

BONSAL SITE									
LIGHTING FIXTURE SCHEDULE									
TYPE	MANUFACTURER	CATALOG NUMBER	DESCRIPTION	LAMPS		VOLTS	DIM TYPE	MOUNTING	REMARKS
				Type	Total Wattage				
SA	GARDCO	ECF-L-80L-1A-NW-G2-AR-4-UNV-CMS-MR7-FINISHPTF2-1-80-FINISHCCOADA13MTG	LED SITE ASSEMBLY W/ DIMMING	LED4K	265	UNV	0-10V	POLE	
SB	GARDCO	ECF-L-80L-1A-NW-G2-AR-5-UNV-CMS-MR7-FINISHPTF2-1-80-FINISHCCOADA13MTG	LED SITE ASSEMBLY W/ DIMMING	LED4K	265	UNV	0-10V	POLE	
LIGHTING SCHEDULE NOTES:									
1. CONTACT SESCO LIGHTING (PATTY ROSSELLIO) @ 951-432-4192 OR prossellio@seco-lighting.com									
2. THE ABOVE FIXTURE SCHEDULE IS PREDICATED ON PERFORMANCE AND IS DESIGNED TO MEET CERTAIN AESTHETIC CRITERIA. ALL ALTERNATIVE SELECTIONS MUST BE SUBMITTED TO THE ARCHITECT FOR APPROVAL TEN (10) DAYS PRIOR TO BID DATE.									
3. SUBMITTAL MUST INCLUDE IFL CERTIFIED PHOTOMETRIC FILES FOR REVIEW OF QUALITY.									
4. NO SUBSTITUTIONS ALLOWED.									

BONSAL SITE									
LIGHTING FIXTURE SCHEDULE									
TYPE	MANUFACTURER	CATALOG NUMBER	DESCRIPTION	LAMPS		VOLTS	DIM TYPE	MOUNTING	REMARKS
				Type	Total Wattage				
SC	GARDCO	ECF-S-64L-1A-NW-G2-AR-4-UNV-CMS-MR7-FINISHPTF2-1-80-FINISHCCOADA13MTG	LED SITE ASSEMBLY W/ DIMMING	LED4K	208	UNV	0-10V	POLE	
LIGHTING SCHEDULE NOTES:									
1. CONTACT SESCO LIGHTING (PATTY ROSSELLIO) @ 951-432-4192 OR prossellio@seco-lighting.com									
2. THE ABOVE FIXTURE SCHEDULE IS PREDICATED ON PERFORMANCE AND IS DESIGNED TO MEET CERTAIN AESTHETIC CRITERIA. ALL ALTERNATIVE SELECTIONS MUST BE SUBMITTED TO THE ARCHITECT FOR APPROVAL TEN (10) DAYS PRIOR TO BID DATE.									
3. SUBMITTAL MUST INCLUDE IFL CERTIFIED PHOTOMETRIC FILES FOR REVIEW OF QUALITY.									
4. NO SUBSTITUTIONS ALLOWED.									

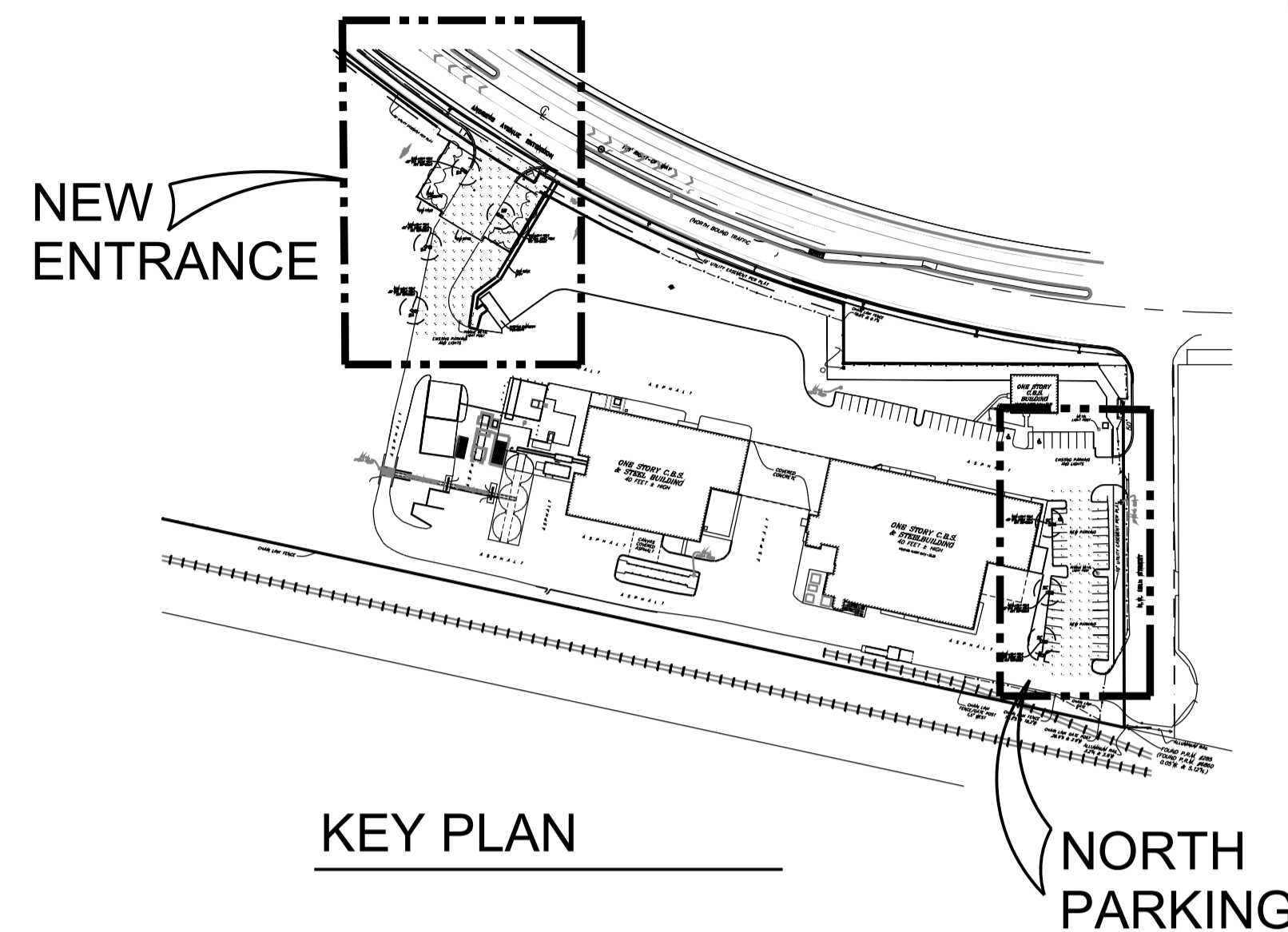

## LIGHT POLE LIGHT TYPES SA, SB & SC

**GARDCO**

EcoForm

ECF-S small area light

Site and Area

EcoForm

ECF-S small area light

**Gardco EcoForm Gen-2** combines economy with performance in an LED area luminaire. Capable of delivering up to 27,800 lumens or more in a compact, low profile LED luminaire, EcoForm offers a new level of customer value. EcoForm features an innovative retrofit arm kit, simplifying site conversions to LED by eliminating the need to drill additional holes in most existing poles. Integral control systems available for further energy savings. Includes Service Tag, our innovative way to provide assistance throughout the life of the product.

Project: \_\_\_\_\_  
Location: \_\_\_\_\_  
Est.No: \_\_\_\_\_  
Type: \_\_\_\_\_  
Lamps: \_\_\_\_\_ Qty: \_\_\_\_\_  
Notes: \_\_\_\_\_

**Ordering guide** Example: ECF-S-64L-900-NW-G2-AR-5-120-HIS-MGY

Prefix	Number of LEDs	Drive Current	LED Color - Generation	Mounting	Distribution	Voltage
ECF-S						
ECF-S	32L 32 LEDs (2 modules)	365 530mA 700 700mA 1A 1200mA	WW-G2 Warm White 3000K, 70CRI Generation 2 NW-G2 Neutral White 4000K, 70CRI Generation 2 CW-G2 Cool White 5000K, 70CRI Generation 2	AM* Arm Mount (stander) The following mounting kits must be ordered separately (See accessories) SP* Slip Fitter Mount (D.I. tenon) WS Wall mount with surface conduit RAM* Retrofit arm mount kit	Type 2 Type 2 2-90 Rotated left 90° 2-270 Rotated right 270° Type 3 Type 3 3-90 Rotated left 90° 3-270 Rotated right 270° Type 4 Type 4 4-90 Rotated left 90° 4-270 Rotated right 270° Type 5 Type 5 5-90 Rotated left 90° 5-270 Rotated right 270°	120 120V 208 208V 240 240V 277 277V 347 347V 480 480V BLC Back Light Control BLC-270 Back Light Control rotated at 270° LCL* LED Corner Optics Left RCL* LED Corner Optics Right HWS 347-480V (50/60Hz)
ECF-S	48L 48 LEDs (3 modules)	900 800mA 1A 1200mA				
ECF-S	64L 64 LEDs (4 modules)	900 800mA 1A 1200mA				

**Options**

Dimming controls: 0-10V External dimming (for controls by others)  
Dual Circuit Control  
FAMS\*\* Field Adjustable Wattage Selector  
SRDR\*\* SR driver connected to Zhaga socket

Motion sensing lens: \_\_\_\_\_

Photo-sensing: \_\_\_\_\_

Options: \_\_\_\_\_

Luminaire: \_\_\_\_\_

Finish: \_\_\_\_\_

**Accessories**

DCP\*\* Photocell Control  
TLRSD\*\* 5 Pin Twist Lock Receptacle  
TLRSD\*\* 7 Pin Twist Lock Receptacle w/PhotoCell

**Dimming controls**

DCP\*\* Photocell Control  
TLRSD\*\* 5 Pin Twist Lock Receptacle  
TLRSD\*\* 7 Pin Twist Lock Receptacle w/PhotoCell

**Accessories**

DCP\*\* Photocell Control  
TLRSD\*\* 5 Pin Twist Lock Receptacle  
TLRSD\*\* 7 Pin Twist Lock Receptacle w/PhotoCell

**Dimming controls**

DCP\*\* Photocell Control  
TLRSD\*\* 5 Pin Twist Lock Receptacle  
TLRSD\*\* 7 Pin Twist Lock Receptacle w/PhotoCell

**Accessories**

DCP\*\* Photocell Control  
TLRSD\*\* 5 Pin Twist Lock Receptacle  
TLRSD\*\* 7 Pin Twist Lock Receptacle w/PhotoCell

## THE BONSA COMPANY NEW PLANT ENTRANCE SITE LIGHTING

Luminaire Schedule	Qty	Label	Description	Lum. Watts	LLF	Lum. Lumens
SA	3	SA	GARDCO#: ECF-L-80L-1A-NW-G2-4 / MTD AT 30' AFG	264	0.900	33657
SB	1	SB	GARDCO#: ECF-L-80L-1A-NW-G2-5 / MTD AT 30' AFG	264	0.900	34615

Calculation Summary	CalcType	Units	Avg	Max	Min	Avg/Min	Max/Min
NEW ENTRANCE	Illuminance	Fc	4.05	6.7	1.6	2.53	4.19

## THE BONSA COMPANY NEW EMPLOYEE PARKING AREA SITE LIGHTING

Luminaire Schedule	Qty	Label	Description	Lum. Watts	LLF	Lum. Lumens
SC	3	SC	GARDCO#: ECF-S-64L-1A-NW-G2-4 / MTD AT 30' AFG	205.9	0.900	27494

Calculation Summary	CalcType	Units	Avg	Max	Min	Avg/Min	Max/Min
NEW PARKING AREA	Illuminance	Fc	3.09	6.0	1.0	3.09	6.00

## LIGHT SPECS

**GHA**  
GALLO HERBERT ARCHITECTS  
1311 W NEWPORT CENTER DRIVE DEERFIELD BEACH, FLORIDA 33442 PH: 954-794-0300 F.X.: 954-794-0300

AA26001731  
[SEAL]  
[ ] WILLIAM J. GALLO FL AR0008440

**Brian Herbert**  
Digitally signed by Brian Herbert  
Date: 2024.06.25 14:44:37 -04'00'  
[ ] BRIAN P. HERBERT FL AR0015474 [PROJECT]

**BONSAL TURN LANE**  
1200 NW 18TH ST  
POMPANO BEACH FL 33069

[OWNER]

OLDCASTLE APG

[REVISIONS]		
No.	Description	Date
1	MINOR SITE SBMTL	07-19-2023
2	MINOR SITE SBMTL	06-25-2024

[PROJECT STATUS]

MINOR SITE PLAN SUBMITTAL

[DATE]  
JUNE 25, 2024

[PROJECT NUMBER]  
2123

[SCALE]  
AS SHOWN

[DRAWN BY] [CHECKED BY]  
JET

[DRAWING TITLE]  
SITE LIGHTING PHOTOMETRIC PLAN

[DRAWING NUMBER]  
SL-2